

Взрывозащищенные коробки выводов серии NXT из высококачественной стали (без фланца)

Зона 1/
Зона 2
Зона 21/
Зона 22



W

Y

Коробка выводов NXT

Технические характеристики

Коробка NXT

Обозначение по 94/9/EG	⊕ II 2 G ⊕ II 2 D T100 °C
Вид защиты от воспламенения	EEx e IIC T6 EEx ia IIC T6 EEx e [ia] IIC T6
Удостоверение соответствия (полное)	KEMA 99 ATEX 3172 X
Удостоверение соответствия (частичное)	KEMA 99 ATEX 3174 U
Вид защиты по EN 60529	IP 66
Номинальное напряжение	До 690 В
Материал корпуса	Высококачественная нержавеющая сталь 316 L (1.4404)
Допустимая наружная температура	от -55 °C до +55 °C

Максимальное число зажимов типа WDU

при установке дин-рейки (шины) типа TS35 вдоль оси W – Y

Коробка	Сечение зажимов, мм ²				Длина шины с зажимами
	2,5	4	6	10	
NXT 221513	1x21	1x17	1x13	1x10	1x109
NXT 262616	2x27	2x23	1x17	1x13	2x140
NXT 262620	2x27	2x23	1x17	1x13	2x140
NXT 303020	2x36	2x30	2x23	2x18	2x186
NXT 453820	3x67	2x56	2x42	2x33	3x338
NXT 484820	4x71	3x59	3x44	3x35	4x360
NXT 503520	3x75	2x63	2x47	2x37	3x380
NXT 745520	5x124	4x103	4x77	4x61	5x620
NXT 866420	6x147	5x123	5x92	4x73	6x740
NXT 987420	7x171	6x143	5x107	5x85	7x860

Размеры в мм

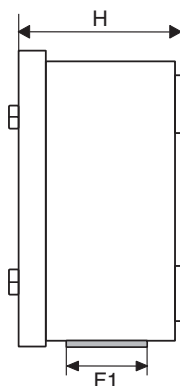

Максимальное количество отверстий для вводов

при установке металлических вводов на стороне W и Y

Коробка	M16	M20	M25	M32	M40	M50
NXT 221513	6	3	2	1	–	–
NXT 262616	20	10	6	3	3	2
NXT 262620	33	15	12	6	5	3
NXT 303020	32	18	15	8	6	3
NXT 453816	29	18	10	6	5	4
NXT 484820	53	30	24	14	11	5
NXT 503520	40	24	18	10	7	4
NXT 745520	60	39	30	18	13	6
NXT 866420	72	45	35	20	13	7
NXT 987420	40	24	18	10	7	4

Размеры в мм

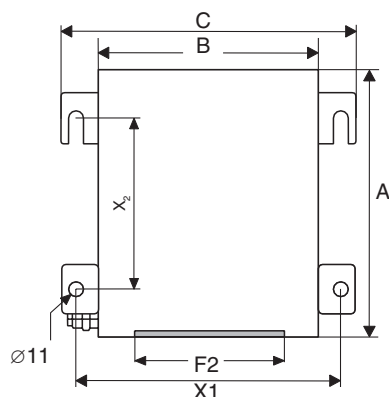

Коробка	A	B	C	H	Крепление		Фланец		Масса, кг (примерно)
					X1	X2	F1	F2	
NXT 221513	229	152	233	130	208	152	58	108	3,25
NXT 262616	260	260	341	160	316	170	80	214	5,5
NXT 262620	260	260	341	205	316	170	124	214	5,5
NXT 303020	306	306	386	205	361	203	124	261	7,0
NXT 453816	458	382	472	205	437	305	124	337	9,75
NXT 484820	480	480	570	205	535	327	124	404	10,4
NXT 503520	500	350	440	205	406	350	124	304	10,5
NXT 745520	740	550	640	205	606	540	124	504	30,4
NXT 866420	860	640	730	205	696	570	124	594	29,0
NXT 987420	980	740	830	205	805	700	124	608	38,0

**Данные для заказа
взрывозащищенных коробок
выводов STB ..., NXT и GHG 74...
из высококачественной стали**

**Зона 1/
Зона 2
Зона 21/
Зона 22**

Данные для заказа

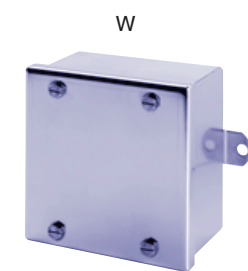

Коробка выводов STB 1



Коробка выводов NXT



Коробка выводов GHG 745 22

Тип	Отверстия/ Линейные вводы	Зажимы/исполнение РЕ-зажима	Номер заказа
STB 12 12	3 x Ø 16,5 мм 1 x Ø 21,0 мм	Резьбовой зажим Ex-e 6 x 2 x 2,5 мм ² UK 3 N РЕ-зажим 6 x 2 x 4 мм ²	STB 100 000 R0001
NXT 22 1513	С фланцем 4 x M20	Резьбовой зажим Ex-e 6 x 2 x 2,5 мм ² UK 3 N РЕ-зажим 6 x 2 x 4 мм ²	NXT S 22 15 13 R0001
STB 1515	6 x Ø 16,5 мм 1 x Ø 26,0 мм	Резьбовой зажим Ex-e 12 x 2 x 2,5 мм ² UK 3 N РЕ-зажим 7 x 2 x 4 мм ²	STB 200 000 R0001
NXT 26 2616	С фланцем 6 x M16 1 x M25	Резьбовой зажим Ex-e 12 x 2 x 2,5 мм ² UK 3 N РЕ-зажим 7 x 2 x 4 мм ²	NXT S 26 26 16 R0001
STB 19 19	12 x Ø 16,5 мм 1 x Ø 26,0 мм	Резьбовой зажим Ex-e 24 x 2 x 2,5 мм ² UK 3 N РЕ-зажим 13 x 2 x 4 мм ²	STB 300 000 R0001
NXT 26 26 20	С фланцем 12 x M16 1 x M32	Резьбовой зажим Ex-e 24 x 2 x 2,5 мм ² UK 3 N РЕ-зажим 13 x 2 x 4 мм ²	NXT S 26 26 20 R0001
STB 16 38	24 x Ø 16,5 мм 1 x Ø 41,0 мм	Резьбовой зажим Ex-e 48 x 2 x 2,5 мм ² UK 3 N РЕ-зажим 25 x 2 x 4 мм ²	STB 500 000 R0001
NXT 30 30 20	С фланцем 24 x M16 1 x M40	Резьбовой зажим Ex-e 48 x 2 x 2,5 мм ² UK 3 N РЕ-зажим 25 x 2 x 4 мм ²	NXT S 30 30 20 R0001
STB 25 40	30 x Ø 16,5 мм 1 x Ø 51,0 мм	Резьбовой зажим Ex-e 60 x 2 x 2,5 мм ² UK 3 N РЕ-зажим 31 x 2 x 4 мм ²	STB 600 000 R0001
NXT 45 38 20	С фланцем 30 x M16 1 x M50	Резьбовой зажим Ex-e 60 x 2 x 2,5 мм ² UK 3 N РЕ-зажим 31 x 2 x 4 мм ²	NXT S 45 38 20 R0001
GHG 744 21	1 фланец без отверстий	Ex-e винтовой зажим 1 x 2 x 2,5 мм ² UK 3 N РЕ-зажим 7x 4 мм ²	GHG 744 2101 R0001
GHG 745 22	1 фланец без отверстий	Ex-e винтовой зажим 1 x 2 x 2,5 мм ² UK 3 N РЕ-зажим 14x 4 мм ²	GHG 745 2201 R0001
GHG 746 23	2 фланца без отверстий	Ex-e винтовой зажим 1 x 2 x 2,5 мм ² UK 3 N РЕ-зажим 2 x 14 x 4 мм ²	GHG 746 2301 R0001
GHG 749 24	3 фланца без отверстий	Ex-e винтовой зажим 1 x 2 x 2,5 мм ² UK 3 N РЕ-зажим 3 x 14 x 4 мм ²	GHG 749 2401 R0001

COOPER Crouse-Hinds

NEXT STEEL ENCLOSURE RANGE



Cooper Crouse-Hinds are premier manufacturers of high quality and robust enclosure solutions and assemblies configured to meet the requirements of the most demanding hazardous area and industrial environmental applications. With over 30 years of experience in the design, engineering and manufacture of enclosure solutions, Cooper Crouse-Hinds provides, tried and tested solutions to meet the toughest project and installation needs.

The NEXT range is an "ATEX certified" heavy-duty enclosure solution fully compliant with the impact, thermal and ingress protection requirements of EN50014. These are available in a wide range of sizes to meet a diverse range of applications.

With our customizing service fittings such as cable glands, breather drains and blanking plugs can be provided and fitted as specified. Additionally appropriately certified components such instrument transmitters and field-bus modules maybe fitted to provide fully certified OEM solutions.

Using the highest quality materials and design benefits the NEXT enclosure range is the industry benchmark for quality and performance enclosure solutions for both electrical and instrumentation applications.



The retained stainless steel slotted hex bolt fastenings provide a rapid means of achieving high integrity ingress protection (IP) of 66 for reliable & rapid environmental protection.



The high integrity "single piece" sealing gasket for superior ingress protection (IP) of 66 and excellent recovery and re-sealing properties for continuous environmental protection.



An integral drainage channel prevents liquids or other solids contaminates from running in or falling into the enclosure when the door is opened, and to minimize gasket path contamination.



An integral external & internal feed through brass earth / ground stud assembly enables rapid and reliable protective earth / ground connection mounted on the side of the enclosure for ease of access.

Material / Finish Options	316L Stainless Steel (1.4404 to EN 10088) with superior "corrosion resistant" electro chemical polish.		
	Sheet Steel - Polyester powder coated to RAL 7032.		
Gasket Material	High integrity "one piece" closed cell chloroprene or optional silicone gasket.		
Door Fixing	Detachable hinged door, stainless steel hinges with captive stainless steel hex fastening screws.		
Enclosure Mounting	4 x external welded lugs, 11mm Ø holes / slots.		
Equipment Mountings	4 x stand off pillars 9mm Ø, 25mm high, tapped M6 x10, for rail or mounting plate.		
Gland Plates	Optional 3mm thick gland plates available in bottom, top, left and right configurations.		
Enclosure Earth	M10 internal / external brass earth stud assembly M6 internal stud on lid & painted gland plates.		
Certified Ingress Protection (IP) Rating	IP66 to EN60529.	Deluge Test (Shell)	Spec. No. DTS 01.
Certified Operating Temp Range	Chloroprene gasket	-45°C (-49°F) to +80°C (176°F)	
	Optional Silicone gasket	-65°C (-85°F) to +135°C (-275°F)	
Certified Ambient Temp Range	Chloroprene gasket	-45°C (-49°F) to +40°C (104°F) for T6.	
		-45°C (-49°F) to +55°C (131°F) for T5.	
	Optional Silicone gasket	-65°C (-85°C) to +40°C (104°F) for T6.	
		-65°C (-85°F) to +55°C (131°F) for T5.	
Certified Impact Resistance	7 J (Nm) to EN 50014.		
Certification	ATEX II 2 GD EEx e II T6 or T5. (KEMA99ATEX3172X).		
	GOST-R.		
	AEx Class 1 Zone 1 AEx e II T6.		
	cULus toUL50 / C22.2 no. 94-M91, types 3S, 4X.		
	Germanischer Lloyd.		

Enclosure / terminal assemblies configured to meet clients specification within certification parameters.
Refer to our website: www.enclosures-crouse-hinds.uk.com for further company & product information.

NEXT - LANDSCAPE ENCLOSURE TECHNICAL DATA

REV. 0205

DIMENSIONS IN mm (HEIGHT X WIDTH X DEPTH)		306 x 350 x 205	380 x 450 x 205	458 x 550 x 205	500 x 640 x 205
FIXING CENTRES (Vert. X Horiz.)		203 x 405	250 x 506	305 x 606	350 x 696
CCH PART REFERENCE		NXT303520	NXT384520	NXT455520	NXT506420
MATERIAL THICKNESS, mm	BODY	1.5	1.5	1.5	2.0
	DOOR	1.5	1.5	1.5	2.0
WEIGHT IN Kg (Empty)		7.7	10.6	14.9	20.9
TERMINAL MOUNTING RAIL					
RAIL FIXING CENTRES	VERT	206	280	358	400
	HORZ	250	350	450	540
OVERALL RAIL LENGTH	VERT	226	300	378	420
	HORZ	270	370	470	560
AVAILABLE GLANDING AREA					
TOP & BOTTOM		304 x 124	404 x 124	504 x 124	594 x 124
LEFT		214 x 124	214 x 124	334 x 124	404 x 124
RIGHT		258 x 124	214 x 124	334 x 124	404 x 124
MAXIMUM ENTRIES					
TOP & BOTTOM	M16	40	53	60	82
	M20	24	30	39	47
	M25	18	24	30	39
	M32	10	14	18	20
	M40	7	11	13	17
	M50	4	5	6	7
	M63	3	4	5	6
LEFT	M16	28	28	44	53
	M20	15	15	26	30
	M25	12	12	21	24
	M32	6	6	11	14
	M40	5	5	9	11
	M50	2	2	4	5
	M63	2	2	3	4
RIGHT	M16	34	28	44	53
	M20	18	15	26	30
	M25	15	12	21	24
	M32	8	6	11	14
	M40	6	5	9	11
	M50	3	2	4	5
	M63	2	2	3	4
TERMINAL CONTENT					
<u>Terminal Type (thk)</u> <u>Row Orientation</u>					
WDU 2.5 (5)	VERT	3 x 36	4 x 36	5 x 67	6 x 75
WDU 4 (6)	VERT	2 x 30	3 x 36	4 x 56	5 x 63
WDU 6 (8)	VERT	2 x 23	3 x 30	4 x 42	5 x 47
WDU 10 (10)	VERT	2 x 18	3 x 23	4 x 33	4 x 37

Please refer to NOTES on main data sheet for Next enclosures

NEXT ENCLOSURE TECHNICAL DATA
(Imperial)

ALL DIMENSIONS IN INCHES (HEIGHT X W IDTH X DEPTH)	9.02 x 5.98 x 5.12	10.24 x 10.24 x 6.3	10.24 x 10.24 x 8.07	12.05 x 12.05 x 6.3	12.05 x 12.05 x 8.07	14.96 x 10.24 x 6.3	14.96 x 10.24 x 8.07	18.03 x 15.04 x 6.3	18.03 x 15.04 x 8.07	18.9 x 18.9 x 8.07	19.69 x 13.78 x 8.07	24.41 x 17.72 x 8.07	29.13 x 21.65 x 8.07	30 x 20 x 8.07	33.86 x 25.2 x 8.07	35.98 x 24.02 x 8.07	38.58 x 29.13 x 8.07
FIXING CENTRES (Vert. X Horiz.)	5.98 x 8.19*	6.69 x 12.44	6.69 x 12.44	0.79 x 1.42*	0.79 x 1.42*	9.84 x 12.44	9.84 x 12.44	12.01 x 17.2*	12.01 x 17.2*	12.87 x 21.06*	13.78 x 15.98	17.72 x 19.92	21.26 x 23.86	20 x 22.2*	22.44 x 27.4	22.01 x 26.22*	27.56 x 31.34
NOTE : 123* - Subtract 1.18mm when no side gland plates																	
CCH PART NUMBER	NXT221513	NXT262616	NXT262620	NXT303016	NXT303020	NXT382616	NXT382620	NXT453816	NXT453820	NXT484820	NXT503520	NXT624520	NXT745520	NXT765020	NXT866420	NXT916120	NXT987420
TB / TBX PART No. CROSS REFERENCE	TB 10 -130	NONE	NONE	TB11 -150	TB11 - 200	NONE	NONE	TB12 - 150	TB 12 - 200	TB 11 - 200	NONE	NONE	NONE	TB 13 - 200	NONE	TB14 -200	NONE
MATERIAL THICKNESS in mm																	
BODY	1.5	1.5	1.5	1.5	1.5	1.5	1.5	1.5	1.5	1.5	1.5	2.0	2.0	2.0	2.0	2.0	2.0
DOOR	1.5	1.5	1.5	1.5	1.5	1.5	1.5	1.5	1.5	1.5	1.5	2.0	2.0	2.0	2.0	2.0	2.0
WEIGHT IN POUNDS (EMPTY ENCLOSURE)	7.15	12.10	12.10	15.40	15.40	15.40	15.40	21.45	21.45	22.88	23.10	37.40	66.88	51.70	63.80	68.20	83.60
TERMINAL MOUNTING RAIL RAIL FIXING CENTRE!	VERT 5.08 HORZ 2.05	6.30 6.30	6.30 6.30	8.11 8.11	8.11 8.11	11.02 7.09	11.02 7.09	14.09 11.10	14.09 11.10	14.96 14.96	15.75 10.24	20.47 13.78	25.20 17.72	26.06 16.06	29.92 21.26	32.05 20.08	34.65 25.20
RAIL LENGTH	VERT 5.87 HORZ 2.83	7.09 7.09	7.09 7.09	8.90 8.90	8.90 8.90	11.81 6.30	11.81 6.30	14.88 11.89	14.88 11.89	15.75 15.75	16.54 10.63	21.26 14.57	25.98 18.50	26.85 16.85	30.71 22.05	32.83 20.87	35.43 25.98
AVAILABLE GLANDING AREA	Top & Bot LEFT RIGHT	4.25 x 2.28 4.25 x 2.28 4.49 x 3.15	8.43 x 3.15 4.49 x 3.15 4.49 x 3.15	8.43 x 4.88 4.49 x 4.88 4.49 x 4.88	10.28 x 3.15 8.43 x 3.15 10.28 x 4.88	10.28 x 4.88 8.43 x 3.15 10.28 x 4.88	8.43 x 3.15 8.43 x 4.88 8.43 x 3.15	8.43 x 4.88 8.43 x 4.88 8.43 x 3.15	13.27 x 3.15 13.27 x 4.88 13.27 x 4.88	13.27 x 3.15 13.27 x 4.88 13.27 x 4.88	15.91 x 4.88 15.91 x 4.88 15.91 x 4.88	11.97 x 4.88 15.91 x 4.88 15.91 x 4.88	15.91 x 4.88 19.84 x 4.88 19.84 x 4.88	15.91 x 4.88 23.39 x 4.88 23.39 x 4.88	23.39 x 4.88 19.84 x 4.88 23.39 x 4.88	23.39 x 4.88 22.28 x 4.25 22.28 x 4.25	2 x (11.97 x 4.88) 2 x (15.91 x 4.88) 2 x (15.91 x 4.88)
MAXIMUM ENTRIES																	
TOP & BOTTOM	1/2" NPT 3 3/4" NPT 2 1" NPT 2 1 1/4" NPT 0 1 1/2" NPT 0 2" NPT 0 2 1/2" NPT 0	11 4 4 3 2 0 0	17 12 7 5 2 2 0	13 5 4 4 3 0 0	20 15 8 7 3 2 2	11 4 4 3 2 0 2	17 12 7 5 5 2 2	18 7 6 5 4 0 0	27 21 11 9 4 3 3	33 26 14 11 5 4 3	24 18 10 8 4 3 2	33 26 14 11 5 4 3	41 32 18 14 6 5 4	33 26 14 11 5 4 3	48 39 21 17 7 6 5	47 24 20 8 7 6 5	48 36 20 16 7 6 5
LEFT	1/2" NPT 3 3/4" NPT 2 1" NPT 2 1 1/4" NPT 0 1 1/2" NPT 0 2" NPT 0 2 1/2" NPT 0	5 2 2 1 1 0 0	8 4 3 3 2 1 1	11 4 4 4 3 0 0	17 12 7 5 3 2 2	11 4 4 3 2 0 2	17 12 7 5 5 2 2	18 7 6 5 4 3 3	27 21 11 9 4 3 3	33 26 14 11 5 4 3	24 18 10 8 4 3 2	33 26 14 11 5 4 3	41 32 18 14 6 5 4	33 26 14 11 5 4 3	48 39 21 16 7 6 5	47 24 20 8 7 6 5	
RIGHT	1/2" NPT 3 3/4" NPT 2 1" NPT 2 1 1/4" NPT 0 1 1/2" NPT 0 2" NPT 0 2 1/2" NPT 0	5 2 2 1 1 0 0	8 4 3 3 2 1 1	13 5 4 4 3 0 0	20 15 8 7 3 2 2	11 4 4 3 2 0 2	17 12 7 5 5 2 2	18 7 6 5 4 3 3	27 21 11 9 4 3 3	33 26 14 11 5 4 3	24 18 10 8 4 3 2	33 26 14 11 5 4 3	41 32 18 14 6 5 4	33 26 14 11 5 4 3	48 39 21 16 7 6 5	47 24 20 8 7 6 5	
TERMINAL CONTENT																	
Terminal Type (thk)	Row Orientation																
WDU 2.5 (5)	VERT	1 x 21	2 x 27	2 x 27	2 x 36	2 x 36	2 x 51	2 x 51	2 x 67	3 x 71	3 x 75	4 x 99	5 x 124	3 x 128	6 x 147	5 x 158	6 x 171
WDU 4 (6)	VERT	1 x 17	2 x 23	2 x 23	2 x 30	2 x 30	2 x 43	2 x 43	2 x 56	3 x 59	2 x 63	3 x 83	4 x 103	3 x 106	5 x 123	5 x 132	6 x 143
WDU 6 (8)	VERT	1 x 13	1 x 17	1 x 17	2 x 23	2 x 23	1 x 32	1 x 32	2 x 42	3 x 44	2 x 47	3 x 62	4 x 77	3 x 80	5 x 92	4 x 99	5 x 107
WDU 10 (10)	VERT	1 x 10	1 x 13	1 x 13	2 x 18	2 x 18	1 x 25	1 x 25	2 x 33	3 x 35	2 x 37	3 x 49	4 x 61	3 x 64	4 x 73	4 x 79	5 x 85
SAK 2.5 (6)	VERT	1 x 17	2 x 23	2 x 23	2 x 30	2 x 30	2 x 43	2 x 43	3 x 56	3 x 56	4 x 59	3 x 63	4 x 83	5 x 103	4 x 106	6 x 143	8 x 143
SAK 4 (6.5)	VERT	1 x 16	2 x 21	2 x 21	2 x 28	2 x 28	2 x 39	2 x 39	3 x 51	3 x 51	4 x 55	3 x 58	4 x 67	4 x 95	4 x 98	5 x 113	7 x 132
SAK 6 (8)	VERT	1 x 13	2 x 17	2 x 17	2 x 23	2 x 23	2 x 32	2 x 32	3 x 42	3 x 42	4 x 44	3 x 47	3 x 62	4 x 77	4 x 80	5 x 92	6 x 107
SAK 10 (10)	VERT	1 x 10	2 x 13	2 x 13	2 x 18	2 x 18	2 x 25	2 x 25	3 x 33	3 x 33	4 x 35	3 x 37	3 x 49	4 x 61	4 x 64	5 x 73	6 x 85

NOTES : - 1. The information provided is based on the physical constraints of the enclosure. Please refer to the certificate for hazardous area applications.
2. This information is for guidance purposes only. Cooper Crouse-Hinds UK Ltd reserves the right to make any necessary changes without notice

PLEASE REFER TO SEPARATE DATA SHEET FOR "LANDSCAPE" SIZES.

**NexT - "Landscape" ENCLOSURE TECHNICAL DATA
(Imperial)**

REV. 0205

ALL DIMENSIONS IN INCHES (HEIGHT X WIDTH X DEPTH)		12.05 x 13.78 x 8.07	14.96 x 17.72 x 8.07	18.03 x 21.65 x 8.07	19.69 x 25.2 x 8.07
CCH PART NUMBER		NXT303020	NXT382620	NXT453820	NXT503520
FIXING CENTRES (Vert. X Horiz.)		15.94 x 7.99	19.92 x 9.84	23.82 x 12.01	27.4 x 12.99
MATERIAL THICKNESS in mm					
	BODY	1.5	1.5	1.5	1.5
	DOOR	1.50	1.50	1.50	1.50
WEIGHT in lbs (empty)		17.0	23.2	32.7	46.1
TERMINAL MOUNTING RAIL					
	RAIL FIXING CENTRES				
	VERT	8.11	11.02	14.09	15.75
	HORZ	9.84	13.78	17.72	21.26
OVERALL RAIL LENGTH					
	VERT	8.90	11.81	14.88	16.54
	HORZ	10.63	14.57	18.5	22.05
AVAILABLE GLANDING AREA					
	Top & Bot	11.97 x 4.88	15.91 x 4.88	19.84 x 4.88	23.39 x 4.88
	LEFT	8.43 x 4.88	8.43 x 4.88	13.15 x 4.88	15.91 x 4.88
	RIGHT	10.16 x 4.88	8.43 x 4.88	13.15 x 4.88	15.91 x 4.88
MAXIMUM ENTRIES		Gland / Hub	Gland / Hub	Gland / Hub	Gland / Hub
TOP & BOTTOM	1/2" NPT	38 / 21	52 / 29	64 / 36	78 / 42
	3/4" NPT	23 / 12	32 / 16	39 / 20	47 / 24
	1" NPT	18 / 10	26 / 13	33 / 17	39 / 21
	1 1/4" NPT	10 / 8	13 / 11	17 / 14	20 / 17
	1 1/2" NPT	8 / 4	11 / 5	14 / 6	17 / 8
	2" NPT	3 / 3	5 / 4	6 / 5	7 / 6
	2 1/2" NPT	3 / 3	4 / 4	5 / 5	6 / 6
LEFT	1/2" NPT	26 / 14	26 / 14	42 / 23	52 / 29
	3/4" NPT	15 / 8	15 / 8	26 / 13	32 / 16
	1" NPT	12 / 6	12 / 6	21 / 11	26 / 13
	1 1/4" NPT	6 / 5	6 / 5	11 / 9	13 / 11
	1 1/2" NPT	5 / 2	5 / 2	9 / 4	11 / 5
	2" NPT	2 / 2	2 / 2	4 / 3	5 / 4
	2 1/2" NPT	2 / 2	2 / 2	3 / 3	4 / 4
RIGHT	1/2" NPT	32 / 18	26 / 14	42 / 23	52 / 29
	3/4" NPT	20 / 10	15 / 8	26 / 13	32 / 16
	1" NPT	15 / 8	12 / 6	21 / 11	26 / 13
	1 1/4" NPT	8 / 7	6 / 5	11 / 9	13 / 11
	2" NPT	3 / 3	2 / 2	4 / 3	5 / 4
	2 1/2" NPT	2 / 2	2 / 2	3 / 3	4 / 4
TERMINAL CONTENT					
Terminal Type / Orientation					
WDU 2.5N (5)	VERT	3 x 36	4 x 36	5 x 67	6 x 75
WDU 2.5 (5)	VERT	2 x 30	3 x 36	4 x 56	5 x 63
WDU 4 (6)	VERT	2 x 23	3 x 30	4 x 42	5 x 47
WDU 6 (8)	VERT	2 x 18	3 x 23	4 x 33	4 x 37

Please refer to NOTES on main data sheet for NexT enclosures

NexT (NXT) Range Enclosure - General Arrangement

